



# MODEL TRC1600

(Energy Recovery Ventilators - ERV)



## Specifications

Ventilation Type: Static Plate, Heat and Humidity Transfer						
Typical Airflow Range: 500-2,000 CFM						
AHRI 1060 Certified Core: Two L125-G5						
Number Motors: Qty 2, 1.0 HP e.a., direct drive blower/motor packages						
Drive HP	V	Hz	Phase	FLA (per motor)	Min. Cir. Amps	Max. Overcurrent Protection Device
1.5	120	60	Single	15.2	34.2	45
	208-230	60	Single	8.2-7.6	18.5	25
	208-230	60	Three	4.6-4.8	10.8	15
	460	60	Three	2.4	5.4	15
Standard Features: Non-Fused Disconnect 24 VAC transformer/relay package Cross-core differential pressure ports						
Filters: Four total, MERV 8 pleated, 20" x 20" x 2" nominal size						
Weight: 406 (unit), 714 lbs (ship weight)						
Shipping Dimensions: 70" L x 47" W x 40" H						

## Airflow Performance

Motor HP	Blower RPM	Turns Open	External Static Pressure (in w.g.)													
			0.0		0.25		0.50		0.75		0.90		1.25		1.50	
			SCFM	BHP	SCFM	BHP	SCFM	BHP	SCFM	BHP	SCFM	BHP	SCFM	BHP	SCFM	BHP
1.5	1148	4	1592	0.7	1480	0.7	1320	0.6	1120	0.5	800	0.4	-	-	-	-
	1304	2	1809	1.0	1720	1.0	1600	0.9	1410	0.8	1250	0.7	975	0.6	630	0.4
	1460	0	2025	1.5	1950	1.4	1845	1.3	1715	1.2	1540	1.1	1400	1.0	1165	0.8

Note: Watts is for the entire unit (two motors)

Note: Airflow performance includes effect of clean, standard filter supplied with unit.

# Dimensions

# MODEL TRC1600

**ABBREVIATIONS**  
 EA: Exhaust Air to Outside  
 RA: Room Air to be Exhausted  
 FA: Fresh Air to Inside  
 OA: Outside Air Intake

**INSTALLATION ORIENTATION**  
 Unit may be installed in any orientation.  
 RA/EA airstream can be switched with OA/FA airstream.

**NOTE:**  
 1. UNLESS OTHERWISE SPECIFIED, DIMENSIONS ARE ROUNDED TO THE NEAREST EIGHTH OF AN INCH.  
 2. SPECIFICATIONS MAY BE SUBJECT TO CHANGE WITHOUT NOTICE.

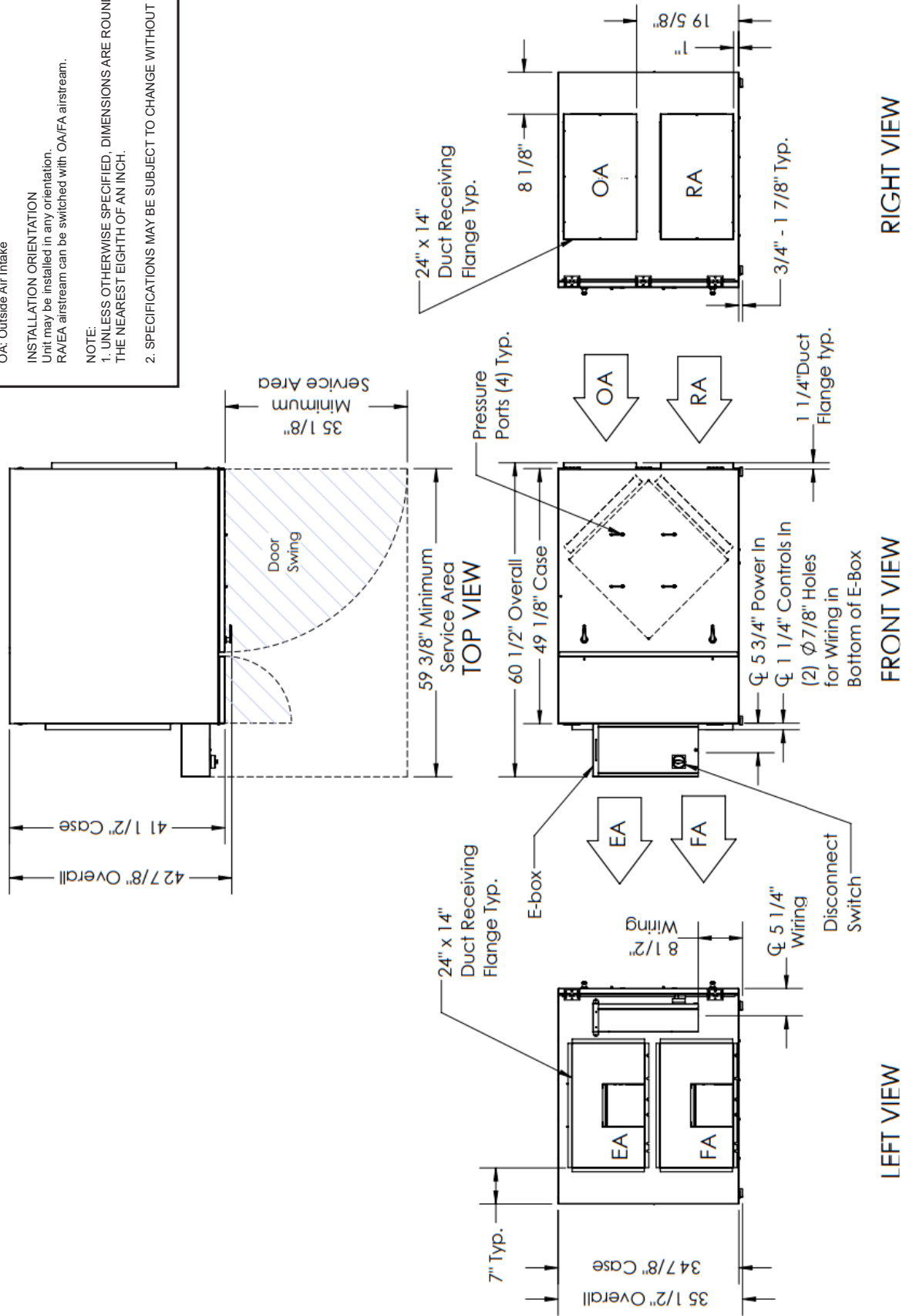

All specifications are subject to change without notice unless approved in submittal by S&P.