



# PCD300IL

## INLINE FAN

Experience efficient ventilation with our multi-speed inline fan, powered by a high-performance EC motor, for residential and light commercial spaces. Perfect for air supply or exhaust applications in homes, offices, restrooms, and workshops, ensuring optimal air quality while minimizing energy costs.



AutoFlo is an innovative technology that automatically increases fan speed in response to rise in static pressure, helping to sustain the set airflow (CFM) as system resistance increases.

### SPECIFICATIONS

#### Standard Features:

- Designed for quiet continuous operation as an inline exhaust or supply air fan.
- The supply air MERV13 filter is available as an optional accessory.
- Set to approximate speeds of 300 CFM, 200 CFM, 150 CFM, 100 CFM. Equipped with knob for speed adjustment.
- Optional dual-speed operation, allowing low-speed continuous use and high-speed activation via a switch. (Switch not included).
- Strong double-inlet centrifugal blower equipped with an energy-efficient EC motor (commonly referred to as DC), featuring AutoFLO™ technology.
- Built-in time delay setting.
- 22 GA galvanized steel housing construction.
- Built-in overload disconnect for safety and longer motor life
- 6" Round duct connection.
- Install inline or in 90° configuration.
- Shipping weight: 15 Lbs.
- Warranty: 5 year against manufacturing defects

#### Optional General Accessories:

- Optional MERV13 Filter: PCD300IL-M13F
- 6" Metal Interior Adjustable Round Grille: BOC150
- 6" Steel Backdraft Damper: CAR150
- 6" Intake Grille with Steel Collar: PG-150
- 6" Plastic Interior Adjustable Round Grille: BOR150
- 6" Aluminum Exterior Fixed Grille: GRA-150
- Vent Light with PAR30 LED Bulb: VLED-100
- 6" Plastic Louver Shutter: PER-150W
- 6" Connector Clamps: ACOP-V150
- 6" Roof Cap: RC-6
- 6" Y Sheet Metal Adapter: SY-6

#### Optional Electric Accessories:

- ASHRAE 62.2 Bath Fan Ventilation Controller: FT622
- Programmable Fan Timer 24 Hour/7 Day: FT247
- 6" Duct Heater 120V: DH6-120V
- 6" Motorized Damper: MD6
- EnviroSense Ventilation Control 24V: ES24V-KIT
- Fan Thermostat: 2513.2E340

### CAN BE USED TO COMPLY WITH

ASHRAE STANDARD 62.1	IRC 2021
ASHRAE STANDARD 62.2	IMC 2021
ASHRAE STANDARD 90.1	IECC 2021

### DIMENSIONS

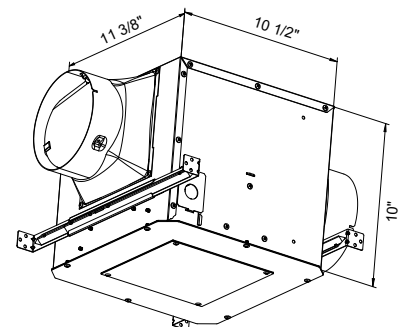
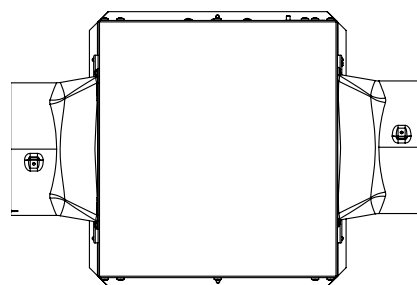
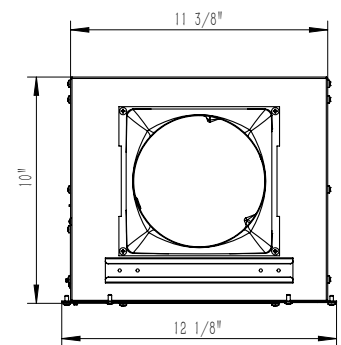
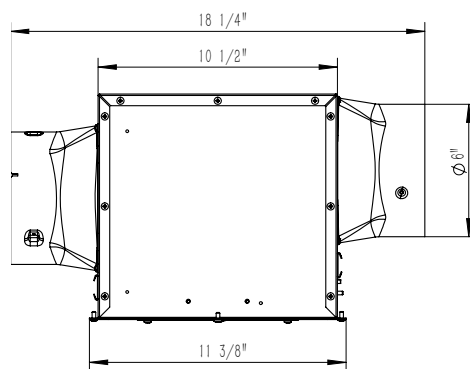

### CERTIFICATIONS





# PCD300IL INLINE FAN



S&P USA Ventilation Systems, LLC certifies that PCD300IL shown herein is licensed to bear the AMCA Seal. The ratings shown are based on tests and procedures performed in accordance with AMCA 211 and comply with the requirements of the AMCA Certified Rating Program.

## AMCA FAN PERFORMANCE

AIRFLOW PERFORMANCE INLINE W/O FILTER											
SPEED SETTING		STATIC PRESSURE IN INCHES W.G.									
		0	0.1	0.2	0.25	0.375	0.4	0.5	0.75	0.8	1
300 CFM	CFM	320	313	302	300	295	293	287	274	271	248
	HP	0.085	0.089	0.098	0.101	0.103	0.106	0.111	0.126	0.13	0.134
200 CFM	CFM	231	225	217	215	213	212	209	201	200	198
	HP	0.034	0.038	0.047	0.05	0.054	0.056	0.062	0.082	0.086	0.101
150 CFM	CFM	156	154	159	159	159	159	157	154	153	146
	HP	0.014	0.018	0.028	0.032	0.035	0.037	0.044	0.063	0.065	0.081
100 CFM	CFM	116	111	110	110	109	109	109	106	105	105
	HP	0.008	0.012	0.019	0.023	0.027	0.027	0.032	0.047	0.051	0.062

Note: Performance certified is for installation Type D: Ducted Inlet, Ducted Outlet. Performance rating do include the effects of appurtenances. AMCA Licensed performance ratings.

## HVI FAN PERFORMANCE

PCD300IL AIRFLOW PERFORMANCE INLINE W/O FILTER							
DUCTING	DISCHARGE	SPEED	SP (IN W.G.)	RATED AIRFLOW (CFM)	INPUT POWER (WATTS)	RATED EFFICACY (CFM/W)	MEETS EFFICIENCY REQUIREMENTS FOR DC, CO, MA, MD, NJ, NV, NY, OR, RI, VT, WA
6"	Horizontal	100 CFM	0.2	100	12	8.3	Yes
		150 CFM		150	18	8.3	
		200 CFM		200	31	6.4	
		300 CFM		300	66	4.5	

## OPERATION

The PCD300 IL model is designed to operate at single-speed or two-speed, to meet ventilation code requirements efficiently. Toggle switches offer four selectable high-speed settings. These represent approximate airflow values. For detailed airflow versus static pressure performance, please refer to this submittal (For instructions on wiring for single-speed or two-speed operation, please refer to the PCD300IL manual.

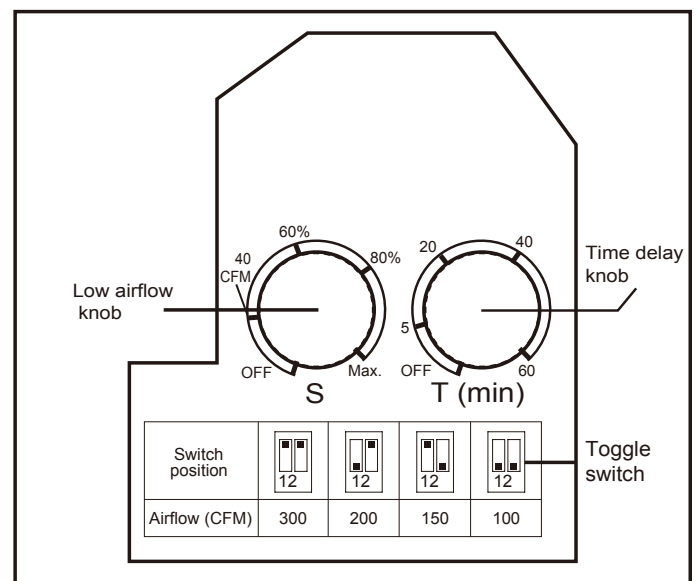



## PCD300IL INLINE FAN

### PCD300IL AS A FRESH AIR SUPPLY FAN: PAIR THE M13 PRE FILTER & ES24V, TO ALLOW FOR

- Operation based on user set minutes per hour
- Setting of high/low outside air temp and humidity settings
- Simultaneous operation with additional duct heater and/or motorized damper



PCD300IL AIRFLOW PERFORMANCE INLINE W/ MERV 13 FILTER

DUCT SIZE	DISCHARGE	SPEED SETTING	SP (IN W.G.)	RATED AIRFLOW (CFM)	INPUT POWER (WATTS)	MEETS EFFICIENCY REQUIREMENTS FOR CO, DC, MA, MD, NJ, NV, NY, OR, RI, VT, WA
6"	HORIZONTAL	100 CFM	0.2	100	18	YES
			0.4	100	97	
			0.6	95	38	
			0.8	95	45	
		150 CFM	0.2	150	30	
			0.4	150	45	
			0.6	140	53	
			0.8	135	60	
		200 CFM	0.2	200	50	
			0.4	200	75	
			0.6	195	75	
			0.8	155	68	
		300 CFM	0.2	270	92	
			0.4	245	97	
			0.6	205	83	
			0.8	160	75	

### FEATURED ELECTRICAL ACCESSORIES



ASHRAE 62.2 Bath Fan  
Ventilation Controller: FT622



Programmable Fan Timer 24  
Hour/7 Day: FT247



6" Duct Heater 120V:  
DH6-120V



6" Motorized Damper: MD6



Envirosense Ventilation  
Control 24V: ES24V-Kit