

INSULATED CANTED ROOF CURB

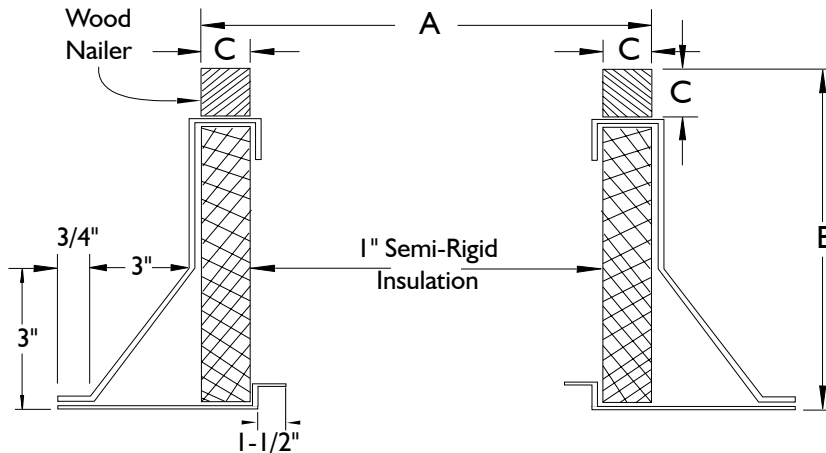

61 A Baywood Road
 Toronto, Ontario M9V 3Y8
 P: 866.733.0233 / F: 866.358.5346
 www.solerpalaucanada.com



OPTIONS:

1. Insulation retainers - solid or screen type.
2. Burglar bars - 1/2" dia. on 6" centers.
3. Finishes - baked or air-dried enamel or epoxy.
4. Heights: 8, 12, or 16".
5. Single pitch, double pitch or flat style.
6. Damper Tray.

FAN SIZE	"A" OD (Square) CURB / RF TYPE					"B" CURB HEIGHT	"C" WOOD NAILER	GAUGES	WEIGHT
	CENTRIFUGAL SUPPLY (1)	CENTRIFUGAL SUPPLY (SRT)	UPBLAST ROOF (2)	TUB (3)	HOODED ROOF (4)				
9	22-3/4	-	-	-	-	12" STD	1-1/2" Sq	18	34
10	26-1/2	14-3/4	-	-	-				36
12	26-1/2	-	-	-	-				36
15	30-1/2	-	-	-	-				36
18	34-5/8	-	-	-	-				40
20	49	-	-	-	-				58
24	-	-	31	33-1/4	33-1/4				39
30	-	-	37	39-1/4	39-1/4				46
36	-	-	43	45-1/4	45-1/4				54
42	-	-	49	51-1/4	51-1/4				61
48	-	-	55	57-1/4	57-1/4				68
54	-	-	61	63-1/4	63-1/4				75
60	-	-	67	69-1/4	69-1/4				82

1. Model - CSF, LSF
2. Model - UBB, UBS, UBX, UBRD
3. Model - TUB, TUBHT
4. Model - HREB-C, HRSB, HRED-C, HRSB, HRSBF, HRSDF
6. Standard construction is shown. If special construction is required, note changes below and highlight.
7. G-90 galvanized welded steel construction.

ACCESSORY ITEMS	1	2	3	4	5	ACCESSORY ITEMS	1	2	3	4	5
<input type="checkbox"/>						<input type="checkbox"/>					
<input type="checkbox"/>						<input type="checkbox"/>					
<input type="checkbox"/>						<input type="checkbox"/>					
<input type="checkbox"/>						<input type="checkbox"/>					
<input type="checkbox"/>						<input type="checkbox"/>					

Project: _____ Submitted: _____
 Customer: _____ Approved: _____
 Location: _____

BACKDRAFT DAMPERS FOR ROOF MOUNTED HOODED EXHAUST PROPELLER FANS



61 A Baywood Road
Toronto, Ontario M9V 3Y8
P: 866.733.0233 / F: 866.358.5346
www.solerpalaucanada.com

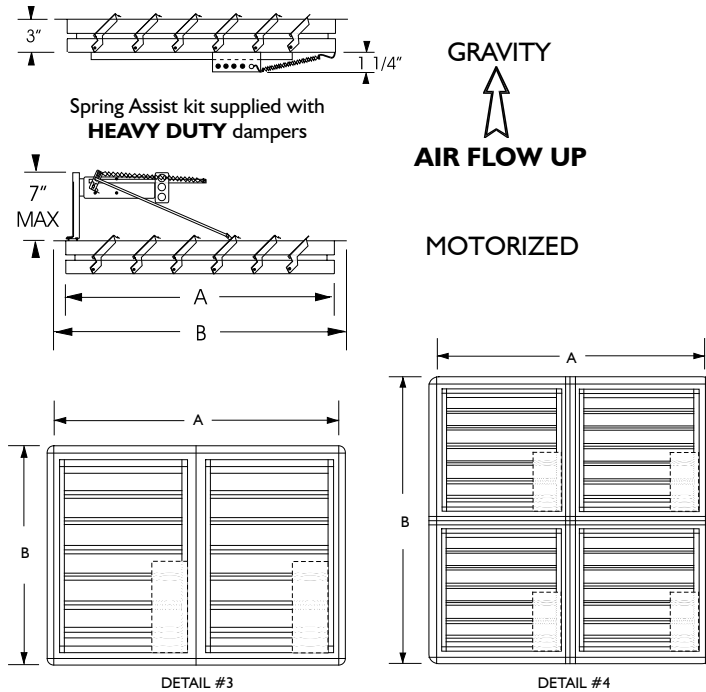

PLAN VIEW

STANDARD SPECIFICATIONS:

- Maximum Face Velocity: 3000 fpm.
- Temperature limits: -40°F to 200°F (-40°C to 94°C)
- Minimum Size: 8 x 8
- Size: Single section: 42 x 64 Max W/H
Multiple section assembly - Unlimited size.
- Frame: 20 gauge galvanized steel.
- Blades: .025 thick aluminum.
HD 28 gauge galvanized steel.
- Seals: Extruded vinyl mechanically locked into blades.
- Axles: Stainless Steel.
- Linkage: Stainless steel pins, galvanized steel tie bar.
- Finish: Mill.

NOTES:

- (1) Do not mount fan less than 12 inches from the shutter.
- (2) Motors available in 24V, 120V, 240V & 440V.
- (3) Dampers shipped in individual cartons.
- (4) Motors and spring kits ship separately.
- (5) Center-pivoted dampers must be used on reversible fans.
- (6) Multiple section assemblies may require bracing to support the weight of the assembly and to hold against system pressure. **BRACING SUPPLIED BY OTHERS.**
- (7) Multiple section dampers are factory joined (except 72" and larger).

CAUTION: Motor kits are not suitable for use in explosive or flammable areas or airflows.

MODELS HREB-C, BHRED-C			DAMPER MOTOR		PANELS (Detail)
FAN SIZE	A Sq SIZE	B Sq OD FLANGE	TYPE	QTY	
24	26	28-1/2	MP2781-S	1	1
30	32	34-1/2	MP2781-S	1	1
36	38	40-1/2	MA220-S	1	1
42	44	46-1/2	MA220-S	1	2
48	50	52-1/2	MA220-S	1	2
54	56	58-1/2	MA220-S	2	3
60	62	65-1/2	MA220-S	2	3
72	76	78-1/2	MA220-S	4	4

Heavy Duty Dampers required on all units with 7 1/2HP motors and above.

ACCESSORY ITEMS	1	2	3	4	5	ACCESSORY ITEMS	1	2	3	4	5
<input type="checkbox"/>						<input type="checkbox"/>					
<input type="checkbox"/>						<input type="checkbox"/>					
<input type="checkbox"/>						<input type="checkbox"/>					
<input type="checkbox"/>						<input type="checkbox"/>					
<input type="checkbox"/>						<input type="checkbox"/>					

Project: _____ Submitted: _____
 Customer: _____ Approved: _____
 Location: _____